

ADDENDUM NO. 2

DATE: July 19, 2023

PROJECT: **Village of Gurnee Public Works Material Bin Reconstruction Project**

OWNER: VILLAGE OF GURNEE

TO: PROSPECTIVE BIDDERS

This Addendum forms a part of the Contract Documents and modifies the Bidding Documents approved for bid, with the amendments as noted below.

This Addendum consists of 3 pages. This Addendum contains the following revisions:

1. Revisions to the plans and clarifications in the Project Manual

CHANGES TO THE CONTRACT DOCUMENTS AND SPECIFICATIONS:

Project Manual:

- Item 1: Response to RFI RE: Addendum No. 1 on Page P-2, Item. 11
 - **QUESTION:** Are items a through f required to be attached with the bid form or post bid?
 - **RESPONSE:** The performance bond and payment bond (forms e & f) are NOT required at time of bid opening. These bonds would be submitted after we've selected the contractor for award. ***Items a, b, c and d are required with the bid.***
- Item 2. Clarification on Sheet S1-1, (1) Foundation Plan:
 - Is (-4'-3 ½") the Top of Footing EL or Bottom of Footing EL?
 - The elevation called out is bottom of footing. See Note 1 on the plans that indicates this.
- Item 3: Modification to sheet S2-0, (2) Typical Slab Section Detail
 - Vapor retarder is not required for the exterior application. It has been removed from the project. See updated detail attached. (Not to scale)

Signed: _____



Heather L. Galan, P.E.
Director of Public Works
Village of Gurnee

ADDENDUM NO. 2

Please acknowledge receipt of this Addendum by signing below and faxing or emailing a copy of the Addendum to the Village of Gurnee, Public Works Department at (847)-599-6800 or publicworks@village.gurnee.il.us. Failure to do may disqualify the Bidder.

_____	_____
Firm	By
_____	_____
Name	Title

ADDENDUM NO. 2

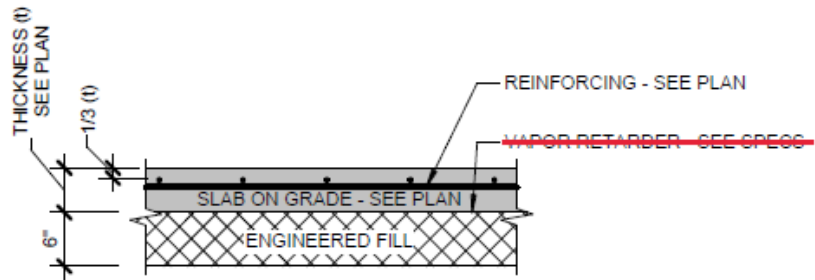

NOTES:

1. REFERENCE SPECIFICATIONS FOR MATERIAL AND COMPACTION REQUIREMENTS.
2. COMPACT ALL FILL MATERIAL TO 95% OF THE MAXIMUM DRY DENSITY PER ASTM D1557.
- ~~3. VAPOR RETARDER TO MEET ASTM E1745, CLASS A AND BE NOT LESS THAN 15 MILS THICK.~~

2 TYPICAL SLAB SECTION

$3/4" = 1'-0"$

(NTS)